

GN 717-NI | Indexing plungers

With or without rest in retracted position, stainless steel

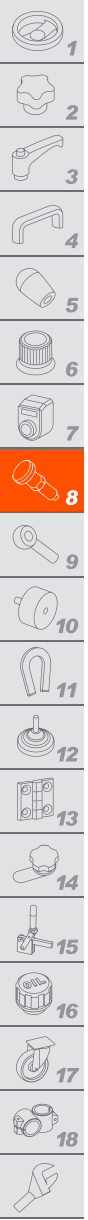

1 THREADED BODY AND LOCKING NUT

AISI 303 stainless steel.

2 PLUNGER

AISI 303 stainless steel.

3 LIFTING RING / OVAL EYELET

AISI 301 stainless steel.

4 SPRING

AISI 301 stainless steel.

5 KNOB

High-resilience polyamide based (PA) technopolymer, black colour, matte finish.

6 STANDARD EXECUTIONS

- GN 717-A-NI: lifting ring, without locking nut.
- GN 717-AK-NI: lifting ring, with locking nut.
- GN 717-B-NI: lifting knob, without locking nut.
- GN 717-BK-NI: lifting knob, with locking nut.
- GN 717-C-NI: lifting knob and rest in retracted position, without locking nut.
- GN 717-CK-NI: lifting knob and rest in retracted position, with locking nut.
- GN 717-D-NI: lifting oval eyelet, without locking nut.
- GN 717-DK-NI: lifting oval eyelet, with locking nut.

7 ACCESSORIES ON REQUEST

AISI 303 stainless steel distance bushings GN 609.5 (see page 1030) for the assembly of the indexing plunger on thin sheets.

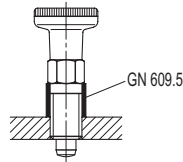

GN 717-A-NI

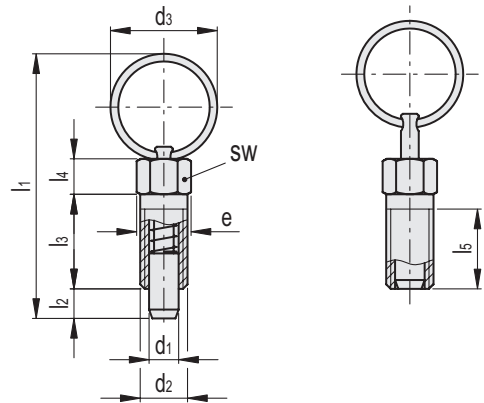

| Conversion Table | |
|-------------------|------|
| 1 mm = 0.039 inch | |
| d1 | |
| mm | inch |
| 3 | 0.12 |
| 4 | 0.16 |
| 5 | 0.20 |
| 6 | 0.24 |
| 8 | 0.31 |
| 10 | 0.39 |

GN 717-A-NI



| Code | Description | d1 | | | | | | | | | | Maximum tightening torque [Nm] | | | |
|----------|------------------------|--------------------------------------|---------|----|------|------|-----|----|-----|------|----|--------------------------------|------|------|----|
| | | Plunger +0 -0.05 Hole +0.03 +0.08 | d2 | d3 | e | l1 | l2 | l3 | l4 | l5 | sw | [N]* | [N]# | [N]Δ | |
| GN.37338 | GN 717-3-M6-A-NI | 3 | M6 | 14 | 6.9 | 33.5 | 3.5 | 12 | 4.5 | 10 | 6 | 2 | 3 | 12 | 4 |
| GN.37335 | GN 717-3-M6X0.75-A-NI | 3 | M6x0.75 | 14 | 6.9 | 33.5 | 3.5 | 12 | 4.5 | 10 | 6 | 3 | 3 | 12 | 4 |
| GN.37361 | GN 717-4-M6-A-NI | 4 | M6 | 14 | 6.9 | 33.5 | 4 | 12 | 4.5 | 10 | 6 | 2 | 3 | 12 | 4 |
| GN.37345 | GN 717-4-M8X1-A-NI | 4 | M8x1 | 14 | 9.2 | 40.4 | 4.5 | 16 | 6 | 13.5 | 8 | 8 | 5 | 24 | 8 |
| GN.37362 | GN 717-5-M8-A-NI | 5 | M8 | 18 | 9.2 | 45 | 5 | 16 | 6 | 13.5 | 8 | 7 | 5 | 24 | 8 |
| GN.37365 | GN 717-5-M8X1-A-NI | 5 | M8x1 | 18 | 9.2 | 45 | 5 | 16 | 6 | 13.5 | 8 | 7 | 5 | 24 | 14 |
| GN.37348 | GN 717-5-M10X1-A-NI | 5 | M10x1 | 18 | 11.5 | 45 | 5 | 16 | 6 | 13.5 | 10 | 22 | 5 | 24 | 17 |
| GN.37363 | GN 717-6-M10-A-NI | 6 | M10 | 24 | 11.5 | 57.1 | 6 | 20 | 7.5 | 17 | 10 | 15 | 5 | 21 | 17 |
| GN.37355 | GN 717-6-M12X1.5-A-NI | 6 | M12x1.5 | 24 | 13.8 | 57.1 | 6 | 20 | 7.5 | 16.5 | 12 | 38 | 5 | 21 | 41 |
| GN.37364 | GN 717-8-M12-A-NI | 8 | M12 | 30 | 13.8 | 71 | 8 | 24 | 9 | 20.5 | 12 | 20 | 6 | 22 | 30 |
| GN.37385 | GN 717-8-M12X1.5-A-NI | 8 | M12x1.5 | 30 | 13.8 | 71 | 8 | 24 | 9 | 20.5 | 12 | 20 | 6 | 22 | 42 |
| GN.37358 | GN 717-8-M16X1.5-A-NI | 8 | M16x1.5 | 30 | 19.6 | 71 | 8 | 24 | 9 | 20.5 | 17 | 80 | 6 | 22 | 54 |
| GN.37405 | GN 717-10-M16X1.5-A-NI | 10 | M16x1.5 | 30 | 19.6 | 74.8 | 10 | 26 | 9 | 22.5 | 17 | 80 | 4 | 27 | 70 |

* Spring preload

Spring maximum load

Indexing and positioning elements

| Conversion Table 1 mm = 0.039 inch | |
|---------------------------------------|------|
| d1 | |
| mm | inch |
| 3 | 0.12 |
| 4 | 0.16 |
| 5 | 0.20 |
| 6 | 0.24 |
| 8 | 0.31 |
| 10 | 0.39 |

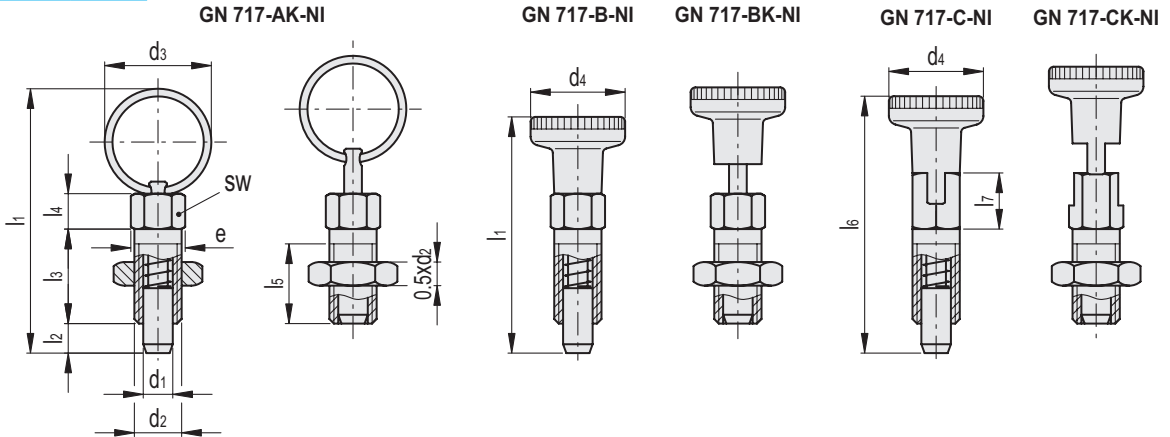

GN 717-AK-NI

| Code | Description | d1 | | | | | | | | | | Maximum tightening torque | | | |
|----------|-------------------------|--------------------------------------|---------|----|------|------|-----|----|-----|------|----|---------------------------|------|------|-----|
| | | Plunger +0 -0.05 Hole +0.03 +0.08 | d2 | d3 | e | l1 | l2 | l3 | l4 | l5 | sw | [Nm] | [N]* | [N]# | ⚖️ |
| GN.37271 | GN 717-3-M6-AK-NI | 3 | M6 | 14 | 6.9 | 33.5 | 3.5 | 12 | 4.5 | 10 | 6 | 2 | 3 | 12 | 4 |
| GN.37268 | GN 717-3-M6X0.75-AK-NI | 3 | M6x0.75 | 14 | 6.9 | 33.5 | 3.5 | 12 | 4.5 | 10 | 6 | 3 | 3 | 12 | 5 |
| GN.37391 | GN 717-4-M6-AK-NI | 4 | M6 | 14 | 6.9 | 33.5 | 4 | 12 | 4.5 | 10 | 6 | 2 | 3 | 12 | 5 |
| GN.37274 | GN 717-4-M8X1-AK-NI | 4 | M8x1 | 14 | 9.2 | 40.4 | 4.5 | 16 | 6 | 13.5 | 8 | 8 | 5 | 24 | 11 |
| GN.37392 | GN 717-5-M8-AK-NI | 5 | M8 | 18 | 9.2 | 45 | 5 | 16 | 6 | 13.5 | 8 | 7 | 5 | 24 | 11 |
| GN.37368 | GN 717-5-M8X1-AK-NI | 5 | M8x1 | 18 | 9.2 | 45 | 5 | 16 | 6 | 13.5 | 8 | 7 | 5 | 24 | 19 |
| GN.37277 | GN 717-5-M10X1-AK-NI | 5 | M10x1 | 18 | 11.5 | 45 | 5 | 16 | 6 | 13.5 | 10 | 22 | 5 | 24 | 22 |
| GN.37393 | GN 717-6-M10-AK-NI | 6 | M10 | 24 | 11.5 | 57.1 | 6 | 20 | 7.5 | 17 | 10 | 15 | 5 | 21 | 22 |
| GN.37280 | GN 717-6-M12X1.5-AK-NI | 6 | M12x1.5 | 24 | 13.8 | 57.1 | 6 | 20 | 7.5 | 16.5 | 12 | 38 | 5 | 21 | 41 |
| GN.37394 | GN 717-8-M12-AK-NI | 8 | M12 | 30 | 13.8 | 71 | 8 | 24 | 9 | 20.5 | 12 | 20 | 6 | 22 | 41 |
| GN.37388 | GN 717-8-M12X1.5-AK-NI | 8 | M12x1.5 | 30 | 13.8 | 71 | 8 | 24 | 9 | 20.5 | 12 | 20 | 6 | 22 | 68 |
| GN.37283 | GN 717-8-M16X1.5-AK-NI | 8 | M16x1.5 | 30 | 19.6 | 71 | 8 | 24 | 9 | 20.5 | 17 | 80 | 6 | 22 | 80 |
| GN.37408 | GN 717-10-M16X1.5-AK-NI | 10 | M16x1.5 | 30 | 19.6 | 74.8 | 10 | 26 | 9 | 22.5 | 17 | 80 | 4 | 27 | 104 |

GN 717-B-NI

| Code | Description | d1 | | | | | | | | | | Maximum tightening torque | | | |
|----------|------------------------|--------------------------------------|---------|----|------|------|-----|----|-----|------|----|---------------------------|------|------|----|
| | | Plunger +0 -0.05 Hole +0.03 +0.08 | d2 | d4 | e | l1 | l2 | l3 | l4 | l5 | sw | [Nm] | [N]* | [N]# | ⚖️ |
| GN.37339 | GN 717-3-M6-B-NI | 3 | M6 | 12 | 6.9 | 30 | 3.5 | 12 | 4.5 | 10 | 6 | 2 | 3 | 12 | 4 |
| GN.37336 | GN 717-3-M6X0.75-B-NI | 3 | M6x0.75 | 12 | 6.9 | 30 | 3.5 | 12 | 4.5 | 10 | 6 | 3 | 3 | 12 | 4 |
| GN.37371 | GN 717-4-M6-B-NI | 4 | M6 | 12 | 6.9 | 30.5 | 4 | 12 | 4.5 | 10 | 6 | 2 | 3 | 12 | 4 |
| GN.37346 | GN 717-4-M8X1-B-NI | 4 | M8x1 | 16 | 9.2 | 39.5 | 4.5 | 16 | 6 | 13.5 | 8 | 8 | 5 | 24 | 9 |
| GN.37372 | GN 717-5-M8-B-NI | 5 | M8 | 16 | 9.2 | 40 | 5 | 16 | 6 | 13.5 | 8 | 7 | 5 | 24 | 9 |
| GN.37366 | GN 717-5-M8X1-B-NI | 5 | M8x1 | 16 | 9.2 | 40 | 5 | 16 | 6 | 13.5 | 8 | 7 | 5 | 24 | 14 |
| GN.37349 | GN 717-5-M10X1-B-NI | 5 | M10x1 | 18 | 11.5 | 42.5 | 5 | 16 | 6 | 13.5 | 10 | 22 | 5 | 24 | 18 |
| GN.37373 | GN 717-6-M10-B-NI | 6 | M10 | 18 | 11.5 | 49 | 6 | 20 | 7.5 | 17 | 10 | 15 | 5 | 21 | 18 |
| GN.37356 | GN 717-6-M12X1.5-B-NI | 6 | M12x1.5 | 21 | 13.8 | 52 | 6 | 20 | 7.5 | 16.5 | 12 | 38 | 5 | 21 | 32 |
| GN.37374 | GN 717-8-M12-B-NI | 8 | M12 | 21 | 13.8 | 59 | 8 | 24 | 9 | 20.5 | 12 | 20 | 6 | 22 | 32 |
| GN.37386 | GN 717-8-M12X1.5-B-NI | 8 | M12x1.5 | 21 | 13.8 | 59 | 8 | 24 | 9 | 20.5 | 12 | 20 | 6 | 22 | 42 |
| GN.37359 | GN 717-8-M16X1.5-B-NI | 8 | M16x1.5 | 25 | 19.6 | 63.5 | 8 | 24 | 9 | 20.5 | 17 | 80 | 6 | 22 | 50 |
| GN.37406 | GN 717-10-M16X1.5-B-NI | 10 | M16x1.5 | 25 | 19.6 | 67.5 | 10 | 26 | 9 | 22.5 | 17 | 80 | 4 | 27 | 70 |

* Spring preload

Spring maximum load

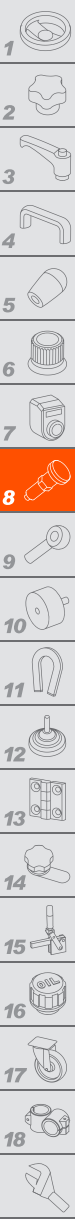

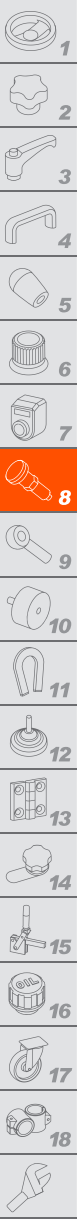

GN 717-BK-NI

INOX STAINLESS STEEL METRIC

| Code | Description | d1 | | | | | | | | | | | Maximum tightening | | |
|----------|-------------------------|-----------------------------------|---------|----|------|------|-----|----|-----|------|----|-------------|--------------------|------|-----|
| | | Plunger +0 -0.05 Hole +0.03 +0.08 | d2 | d4 | e | l1 | l2 | l3 | l4 | l5 | sw | torque [Nm] | [N]* | [N]# | ΔΔ |
| GN.37272 | GN 717-3-M6-BK-NI | 3 | M6 | 12 | 6.9 | 30 | 3.5 | 12 | 4.5 | 10 | 6 | 2 | 3 | 12 | 4 |
| GN.37269 | GN 717-3-M6X0.75-BK-NI | 3 | M6x0.75 | 12 | 6.9 | 30 | 3.5 | 12 | 4.5 | 10 | 6 | 3 | 3 | 12 | 5 |
| GN.37401 | GN 717-4-M6-BK-NI | 4 | M6 | 12 | 6.9 | 30.5 | 4 | 12 | 4.5 | 10 | 6 | 2 | 3 | 12 | 5 |
| GN.37275 | GN 717-4-M8X1-BK-NI | 4 | M8x1 | 16 | 9.2 | 39.5 | 4.5 | 16 | 6 | 13.5 | 8 | 8 | 5 | 24 | 12 |
| GN.37402 | GN 717-5-M8-BK-NI | 5 | M8 | 16 | 9.2 | 40 | 5 | 16 | 6 | 13.5 | 8 | 7 | 5 | 24 | 12 |
| GN.37369 | GN 717-5-M8X1-BK-NI | 5 | M8x1 | 16 | 9.2 | 40 | 5 | 16 | 6 | 13.5 | 8 | 7 | 5 | 24 | 19 |
| GN.37278 | GN 717-5-M10X1-BK-NI | 5 | M10x1 | 18 | 11.5 | 42.5 | 5 | 16 | 6 | 13.5 | 10 | 22 | 5 | 24 | 23 |
| GN.37403 | GN 717-6-M10-BK-NI | 6 | M10 | 18 | 11.5 | 49 | 6 | 20 | 7.5 | 17 | 10 | 15 | 5 | 21 | 23 |
| GN.37281 | GN 717-6-M12X1.5-BK-NI | 6 | M12x1.5 | 21 | 13.8 | 52 | 6 | 20 | 7.5 | 16.5 | 12 | 38 | 5 | 21 | 43 |
| GN.37404 | GN 717-8-M12-BK-NI | 8 | M12 | 21 | 13.8 | 59 | 8 | 24 | 9 | 20.5 | 12 | 20 | 6 | 22 | 43 |
| GN.37389 | GN 717-8-M12X1.5-BK-NI | 8 | M12x1.5 | 21 | 13.8 | 59 | 8 | 24 | 9 | 20.5 | 12 | 20 | 6 | 22 | 68 |
| GN.37284 | GN 717-8-M16X1.5-BK-NI | 8 | M16x1.5 | 25 | 19.6 | 63.5 | 8 | 24 | 9 | 20.5 | 17 | 80 | 6 | 22 | 80 |
| GN.37409 | GN 717-10-M16X1.5-BK-NI | 10 | M16x1.5 | 25 | 19.6 | 67.5 | 10 | 26 | 9 | 22.5 | 17 | 80 | 4 | 27 | 104 |

GN 717-C-NI

INOX STAINLESS STEEL METRIC

| Code | Description | d1 | | | | | | | | | | | Maximum tightening | | |
|----------|------------------------|-----------------------------------|---------|----|------|-----|----|------|------|------|----|-------------|--------------------|------|----|
| | | Plunger +0 -0.05 Hole +0.03 +0.08 | d2 | d4 | e | l2 | l3 | l5 | l6 | l7 | sw | torque [Nm] | [N]* | [N]# | ΔΔ |
| GN.37340 | GN 717-3-M6-C-NI | 3 | M6 | 12 | 6.9 | 3.5 | 12 | 10 | 32.5 | 7 | 6 | 2 | 3 | 12 | 4 |
| GN.37337 | GN 717-3-M6X0.75-C-NI | 3 | M6x0.75 | 12 | 6.9 | 3.5 | 12 | 10 | 32.5 | 7 | 6 | 3 | 3 | 12 | 4 |
| GN.37381 | GN 717-4-M6-C-NI | 4 | M6 | 12 | 6.9 | 4 | 12 | 10 | 33 | 7 | 6 | 2 | 3 | 12 | 4 |
| GN.37347 | GN 717-4-M8X1-C-NI | 4 | M8x1 | 16 | 9.2 | 4.5 | 16 | 13.5 | 43 | 9.5 | 8 | 8 | 5 | 24 | 10 |
| GN.37382 | GN 717-5-M8-C-NI | 5 | M8 | 16 | 9.2 | 5 | 16 | 13.5 | 43.5 | 9.5 | 8 | 7 | 5 | 24 | 10 |
| GN.37367 | GN 717-5-M8X1-C-NI | 5 | M8x1 | 16 | 9.2 | 5 | 16 | 13.5 | 43.5 | 9.5 | 8 | 7 | 5 | 24 | 16 |
| GN.37350 | GN 717-5-M10X1-C-NI | 5 | M10x1 | 18 | 11.5 | 5 | 16 | 13.5 | 46 | 9.5 | 10 | 22 | 5 | 24 | 19 |
| GN.37383 | GN 717-6-M10-C-NI | 6 | M10 | 18 | 11.5 | 6 | 20 | 17 | 52 | 10.5 | 10 | 15 | 5 | 21 | 19 |
| GN.37357 | GN 717-6-M12X1.5-C-NI | 6 | M12x1.5 | 21 | 13.8 | 6 | 20 | 16.5 | 55 | 10.5 | 12 | 38 | 5 | 21 | 35 |
| GN.37384 | GN 717-8-M12-C-NI | 8 | M12 | 21 | 13.8 | 8 | 24 | 20.5 | 63.5 | 13.5 | 12 | 20 | 6 | 22 | 35 |
| GN.37387 | GN 717-8-M12X1.5-C-NI | 8 | M12x1.5 | 21 | 13.8 | 8 | 24 | 20.5 | 63.5 | 13.5 | 12 | 20 | 6 | 22 | 48 |
| GN.37360 | GN 717-8-M16X1.5-C-NI | 8 | M16x1.5 | 25 | 19.6 | 8 | 24 | 20.5 | 68 | 13.5 | 17 | 80 | 6 | 22 | 60 |
| GN.37407 | GN 717-10-M16X1.5-C-NI | 10 | M16x1.5 | 25 | 19.6 | 10 | 26 | 22.5 | 72.5 | 14 | 17 | 80 | 4 | 27 | 80 |

GN 717-CK-NI

INOX STAINLESS STEEL METRIC

| Code | Description | d1 | | | | | | | | | | | Maximum tightening | | |
|----------|-------------------------|-----------------------------------|---------|----|------|-----|----|------|------|------|----|-------------|--------------------|------|-----|
| | | Plunger +0 -0.05 Hole +0.03 +0.08 | d2 | d4 | e | l2 | l3 | l5 | l6 | l7 | sw | torque [Nm] | [N]* | [N]# | ΔΔ |
| GN.37273 | GN 717-3-M6-CK-NI | 3 | M6 | 12 | 6.9 | 3.5 | 12 | 10 | 32.5 | 7 | 6 | 2 | 3 | 12 | 4 |
| GN.37270 | GN 717-3-M6X0.75-CK-NI | 3 | M6x0.75 | 12 | 6.9 | 3.5 | 12 | 10 | 32.5 | 7 | 6 | 3 | 3 | 12 | 5 |
| GN.37411 | GN 717-4-M6-CK-NI | 4 | M6 | 12 | 6.9 | 4 | 12 | 10 | 33 | 7 | 6 | 2 | 3 | 12 | 5 |
| GN.37276 | GN 717-4-M8X1-CK-NI | 4 | M8x1 | 16 | 9.2 | 4.5 | 16 | 13.5 | 43 | 9.5 | 8 | 8 | 5 | 24 | 12 |
| GN.37412 | GN 717-5-M8-CK-NI | 5 | M8 | 16 | 9.2 | 5 | 16 | 13.5 | 43.5 | 9.5 | 8 | 7 | 5 | 24 | 12 |
| GN.37370 | GN 717-5-M8X1-CK-NI | 5 | M8x1 | 16 | 9.2 | 5 | 16 | 13.5 | 43.5 | 9.5 | 8 | 7 | 5 | 24 | 18 |
| GN.37279 | GN 717-5-M10X1-CK-NI | 5 | M10x1 | 18 | 11.5 | 5 | 16 | 13.5 | 46 | 9.5 | 10 | 22 | 5 | 24 | 24 |
| GN.37413 | GN 717-6-M10-CK-NI | 6 | M10 | 18 | 11.5 | 6 | 20 | 17 | 52 | 10.5 | 10 | 15 | 5 | 21 | 24 |
| GN.37282 | GN 717-6-M12X1.5-CK-NI | 6 | M12x1.5 | 21 | 13.8 | 6 | 20 | 16.5 | 55 | 10.5 | 12 | 38 | 5 | 21 | 46 |
| GN.37414 | GN 717-8-M12-CK-NI | 8 | M12 | 21 | 13.8 | 8 | 24 | 20.5 | 63.5 | 13.5 | 12 | 20 | 6 | 22 | 46 |
| GN.37390 | GN 717-8-M12X1.5-CK-NI | 8 | M12x1.5 | 21 | 13.8 | 8 | 24 | 20.5 | 63.5 | 13.5 | 12 | 20 | 6 | 22 | 68 |
| GN.37285 | GN 717-8-M16X1.5-CK-NI | 8 | M16x1.5 | 25 | 19.6 | 8 | 24 | 20.5 | 68 | 13.5 | 17 | 80 | 6 | 22 | 80 |
| GN.37410 | GN 717-10-M16X1.5-CK-NI | 10 | M16x1.5 | 25 | 19.6 | 10 | 26 | 22.5 | 72.5 | 14 | 17 | 80 | 4 | 27 | 110 |

* Spring preload
Spring maximum load

Indexing and positioning elements

| Conversion Table 1 mm = 0.039 inch | |
|---------------------------------------|------|
| d1 | |
| mm | inch |
| 3 | 0.12 |
| 4 | 0.16 |
| 5 | 0.20 |
| 6 | 0.24 |
| 8 | 0.31 |
| 10 | 0.39 |

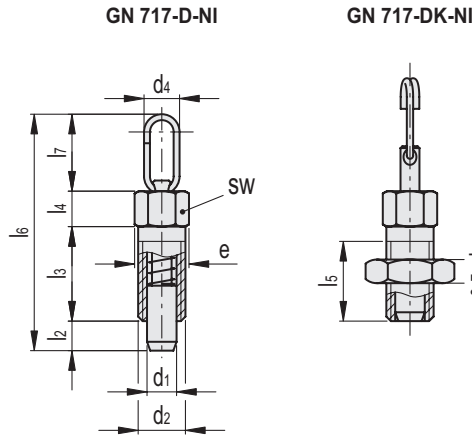

GN 717-D-NI

INOX STAINLESS STEEL METRIC

| Code | Description | d1 | | | | | | | | | | | Maximum tightening torque | | | |
|----------|------------------------|--------------------------------------|---------|------|------|-----|----|-----|------|------|------|----|---------------------------|------|------|----|
| | | Plunger +0 -0.05 Hole +0.03 +0.08 | d2 | d4 | e | l2 | l3 | l4 | l5 | l6 | l7 | sw | [Nm] | [N]* | [N]# | Δ |
| GN.36201 | GN 717-3-M6-D-NI | 3 | M6 | 6 | 6.9 | 3.5 | 12 | 4.5 | 10 | 32.9 | 12.9 | 6 | 2 | 3 | 12 | 4 |
| GN.36202 | GN 717-3-M6X0.75-D-NI | 3 | M6x0.75 | 6 | 6.9 | 3.5 | 12 | 4.5 | 10 | 32.9 | 12.9 | 6 | 3 | 3 | 12 | 4 |
| GN.36204 | GN 717-4-M6-D-NI | 4 | M6 | 6 | 6.9 | 4 | 12 | 4.5 | 10 | 33.4 | 12.9 | 6 | 2 | 3 | 12 | 4 |
| GN.36205 | GN 717-4-M8X1-D-NI | 4 | M8x1 | 6 | 9.2 | 4.5 | 16 | 6 | 13.5 | 42 | 15.5 | 8 | 8 | 5 | 24 | 9 |
| GN.36207 | GN 717-5-M8-D-NI | 5 | M8 | 7.2 | 9.2 | 5 | 16 | 6 | 13.5 | 42.5 | 15.5 | 8 | 7 | 5 | 24 | 12 |
| GN.36208 | GN 717-5-M8X1-D-NI | 5 | M8x1 | 7.2 | 9.2 | 5 | 16 | 6 | 13.5 | 42.5 | 15.5 | 8 | 7 | 5 | 24 | 9 |
| GN.36209 | GN 717-5-M10X1-D-NI | 5 | M10x1 | 7.2 | 11.5 | 5 | 16 | 6 | 13.5 | 42.5 | 15.5 | 10 | 22 | 5 | 24 | 17 |
| GN.36211 | GN 717-6-M10-D-NI | 6 | M10 | 9.5 | 11.5 | 6 | 20 | 7.5 | 17 | 54.4 | 20.9 | 10 | 15 | 5 | 21 | 15 |
| GN.36212 | GN 717-6-M12X1.5-D-NI | 6 | M12x1.5 | 9.5 | 13.8 | 6 | 20 | 7.5 | 16.5 | 54.4 | 20.9 | 12 | 38 | 5 | 21 | 21 |
| GN.36214 | GN 717-8-M12-D-NI | 8 | M12 | 11.8 | 13.8 | 8 | 24 | 9 | 20.5 | 66.9 | 25.9 | 12 | 20 | 6 | 22 | 33 |
| GN.36215 | GN 717-8-M12X1.5-D-NI | 8 | M12x1.5 | 11.8 | 13.8 | 8 | 24 | 9 | 20.5 | 66.9 | 25.9 | 12 | 20 | 6 | 22 | 29 |
| GN.36216 | GN 717-8-M16X1.5-D-NI | 8 | M16x1.5 | 11.8 | 19.6 | 8 | 24 | 9 | 20.5 | 66.9 | 25.9 | 17 | 80 | 6 | 22 | 52 |
| GN.36218 | GN 717-10-M16X1.5-D-NI | 10 | M16x1.5 | 11.8 | 19.6 | 10 | 26 | 9 | 22.5 | 70.9 | 25.9 | 17 | 80 | 4 | 27 | 54 |

GN 717-DK-NI

INOX STAINLESS STEEL METRIC

| Code | Description | d1 | | | | | | | | | | | Maximum tightening torque | | | |
|----------|-------------------------|--------------------------------------|---------|------|------|-----|----|-----|------|------|------|----|---------------------------|------|------|----|
| | | Plunger +0 -0.05 Hole +0.03 +0.08 | d2 | d4 | e | l2 | l3 | l4 | l5 | l6 | l7 | sw | [Nm] | [N]* | [N]# | Δ |
| GN.36241 | GN 717-3-M6-DK-NI | 3 | M6 | 6 | 6.9 | 3.5 | 12 | 4.5 | 10 | 32.9 | 12.9 | 6 | 2 | 3 | 12 | 5 |
| GN.36242 | GN 717-3-M6X0.75-DK-NI | 3 | M6x0.75 | 6 | 6.9 | 3.5 | 12 | 4.5 | 10 | 32.9 | 12.9 | 6 | 3 | 3 | 12 | 5 |
| GN.36244 | GN 717-4-M6-DK-NI | 4 | M6 | 6 | 6.9 | 4 | 12 | 4.5 | 10 | 33.4 | 12.9 | 6 | 2 | 3 | 12 | 6 |
| GN.36245 | GN 717-4-M8X1-DK-NI | 4 | M8x1 | 6 | 9.2 | 4.5 | 16 | 6 | 13.5 | 42 | 15.5 | 8 | 8 | 5 | 24 | 12 |
| GN.36247 | GN 717-5-M8-DK-NI | 5 | M8 | 7.2 | 9.2 | 5 | 16 | 6 | 13.5 | 42.5 | 15.5 | 8 | 7 | 5 | 24 | 12 |
| GN.36248 | GN 717-5-M8X1-DK-NI | 5 | M8x1 | 7.2 | 9.2 | 5 | 16 | 6 | 13.5 | 42.5 | 15.5 | 8 | 7 | 5 | 24 | 12 |
| GN.36249 | GN 717-5-M10X1-DK-NI | 5 | M10x1 | 7.2 | 11.5 | 5 | 16 | 6 | 13.5 | 42.5 | 15.5 | 10 | 22 | 5 | 24 | 20 |
| GN.36251 | GN 717-6-M10-DK-NI | 6 | M10 | 9.5 | 11.5 | 6 | 20 | 7.5 | 17 | 54.4 | 20.9 | 10 | 15 | 5 | 21 | 25 |
| GN.36252 | GN 717-6-M12X1.5-DK-NI | 6 | M12x1.5 | 9.5 | 13.8 | 6 | 20 | 7.5 | 16.5 | 54.4 | 20.9 | 12 | 38 | 5 | 21 | 34 |
| GN.36254 | GN 717-8-M12-DK-NI | 8 | M12 | 11.8 | 13.8 | 8 | 24 | 9 | 20.5 | 66.9 | 25.9 | 12 | 20 | 6 | 22 | 42 |
| GN.36255 | GN 717-8-M12X1.5-DK-NI | 8 | M12x1.5 | 11.8 | 13.8 | 8 | 24 | 9 | 20.5 | 66.9 | 25.9 | 12 | 20 | 6 | 22 | 42 |
| GN.36256 | GN 717-8-M16X1.5-DK-NI | 8 | M16x1.5 | 11.8 | 19.6 | 8 | 24 | 9 | 20.5 | 66.9 | 25.9 | 17 | 80 | 6 | 22 | 78 |
| GN.36258 | GN 717-10-M16X1.5-DK-NI | 10 | M16x1.5 | 11.8 | 19.6 | 10 | 26 | 9 | 22.5 | 70.9 | 25.9 | 17 | 80 | 4 | 27 | 72 |

* Spring preload
Spring maximum load

